

0,50 κάλυψη κατά μήκος
0,70 αποσπώμενη κορώνα
0,15
0,15

[illegible]

ΤΟΜΗ Α-Α Κλίμακα 1: 10

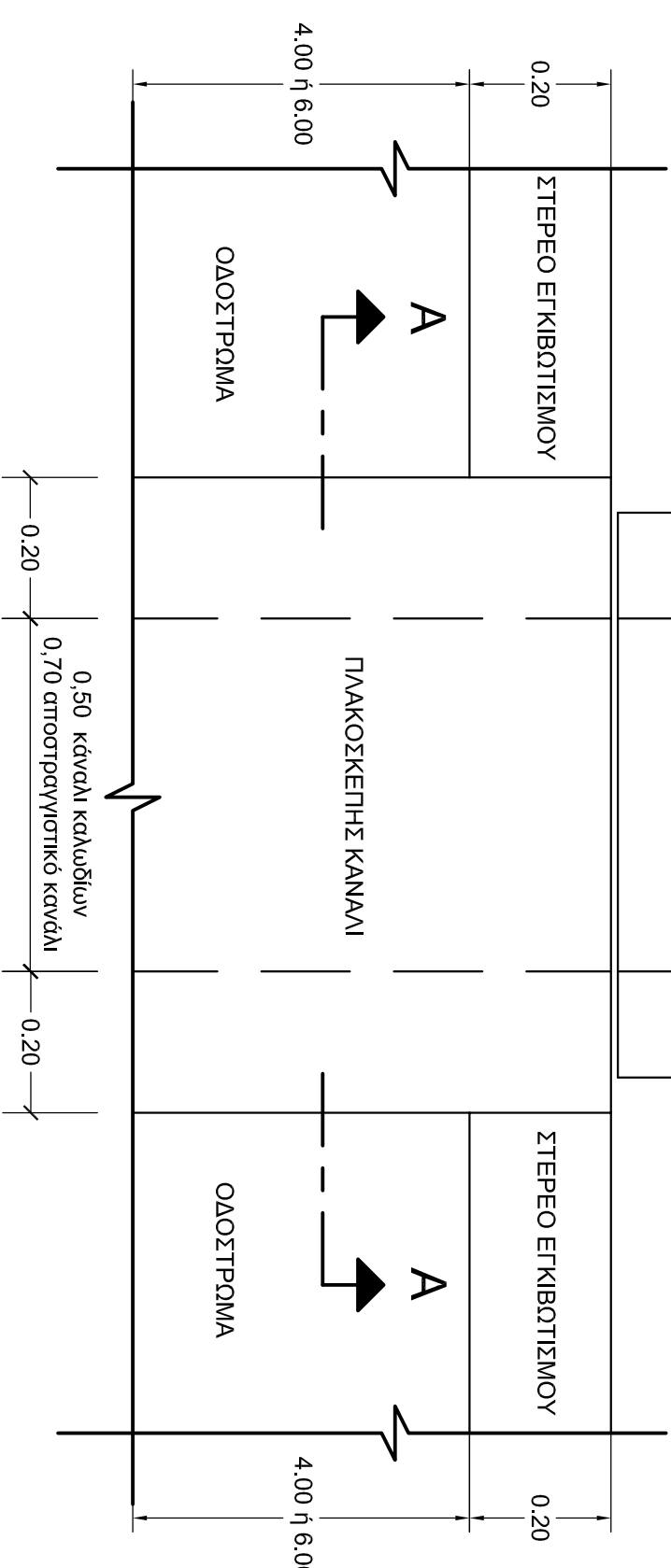
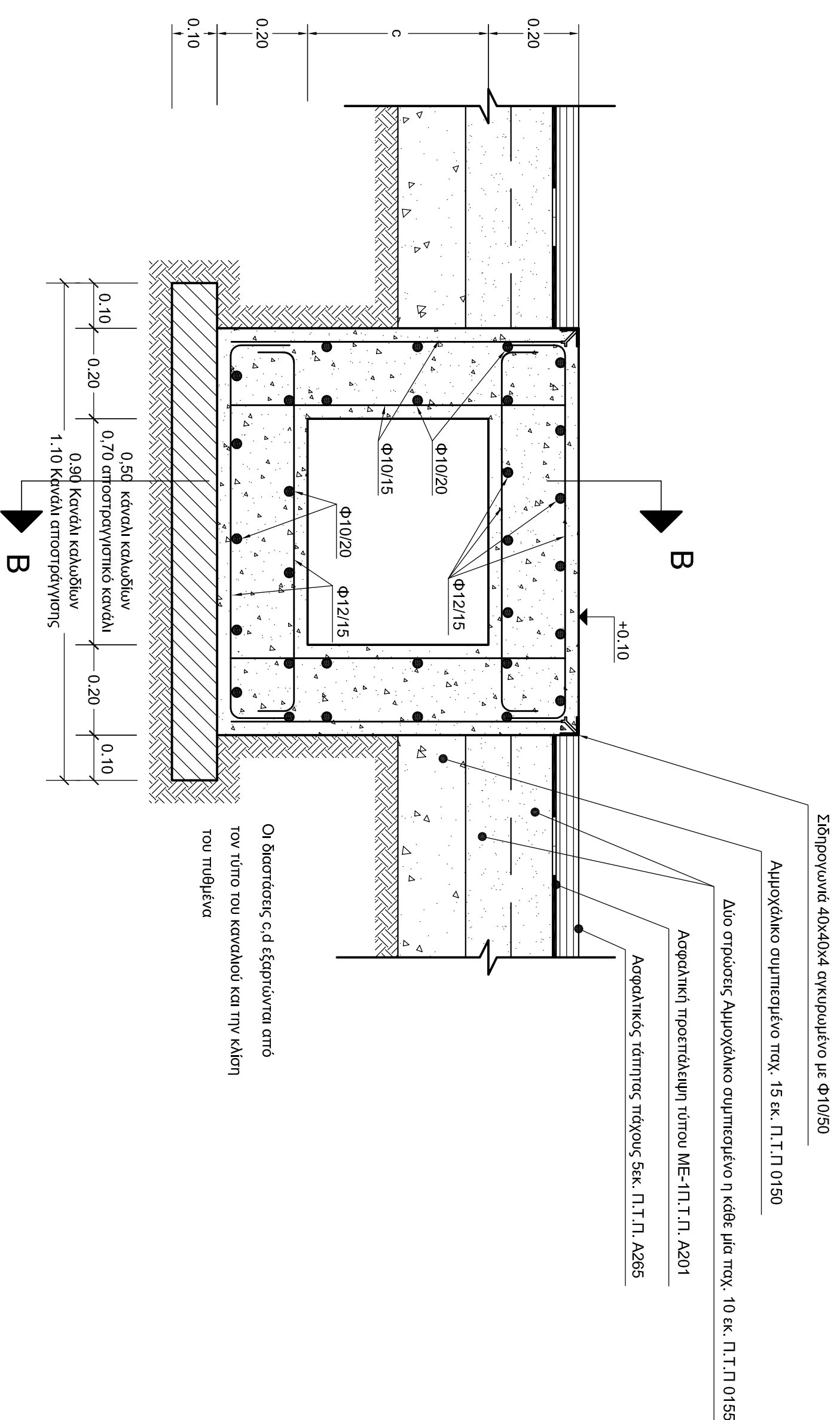
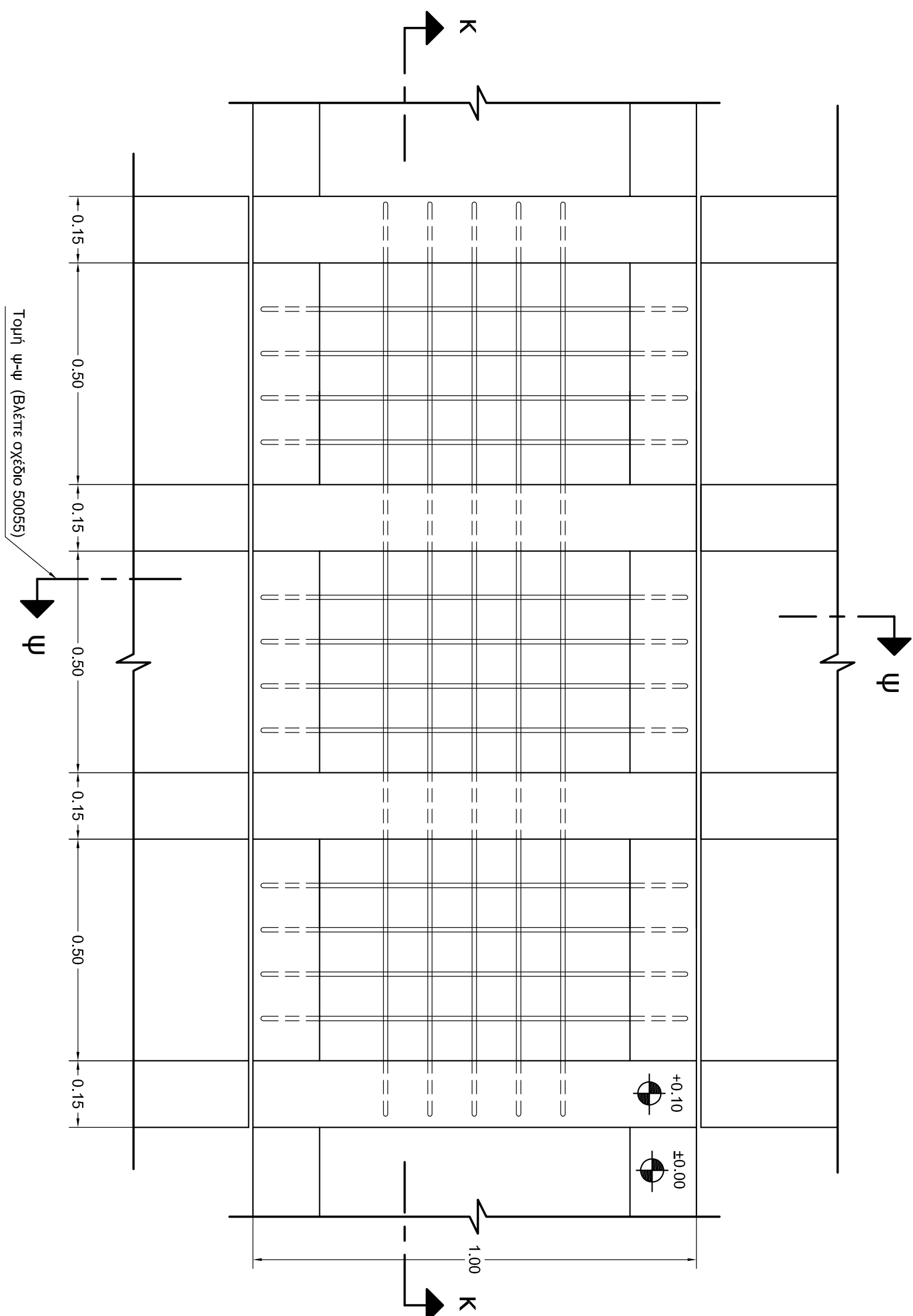
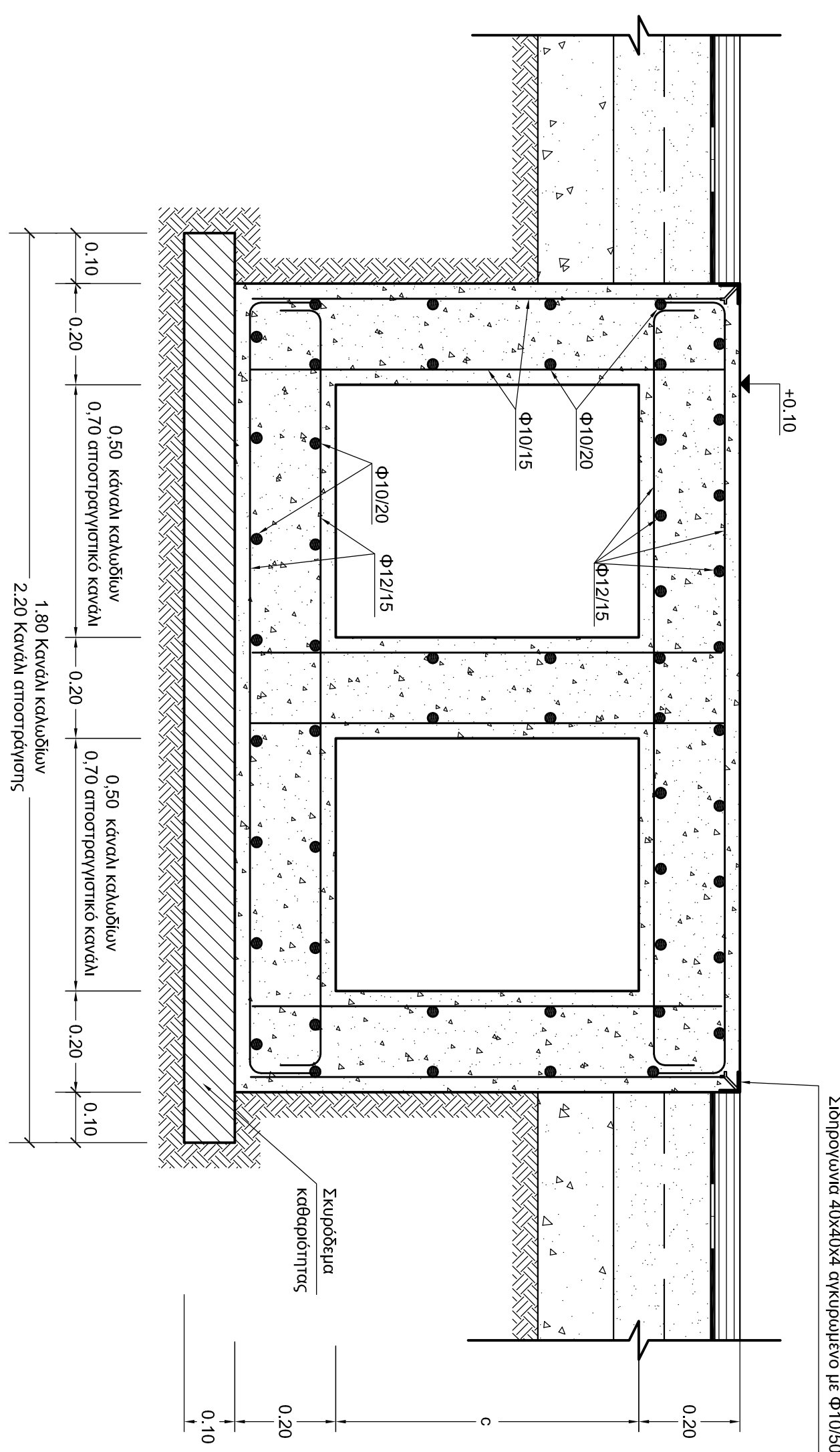

Figure 1 is a schematic diagram of the experimental setup. It shows a cross-section of a substrate with three distinct layers. The top layer is labeled 'Wood chips' and has a thickness of 0.15 m. The middle layer is labeled 'Straw' and has a thickness of 0.15 m. The bottom layer is labeled 'Microorganisms' and has a thickness of 0.15 m. The total thickness of the substrate is 0.45 m. The diagram also shows the dimensions of the substrate and the layers, and the location of the microorganisms. The substrate is divided into three sections: a control section (left), a section with a layer of microorganisms (middle), and a section with a layer of microorganisms and a layer of wood chips (right). The control section has a thickness of 0.15 m. The middle section has a thickness of 0.15 m and contains a layer of microorganisms. The right section has a thickness of 0.15 m and contains a layer of microorganisms and a layer of wood chips. The total thickness of the substrate is 0.45 m. The diagram also shows the dimensions of the substrate and the layers, and the location of the microorganisms.

Σε διασταύρωση με τόφορο αποστράγγιση



ТОМН Г-Г Каймака 1: 10



ΤΥΠΙΚΕΣ ΔΙΑΤΟΜΕΣ ΚΑΝΑΛΙΩΝ ΚΑΛΩΔΙΩΝ
ΚΑΤΟΥΕΙΣ - ΤΟΜΕΣ

ΣΥΣΤΑΣΗ	ΜΕΛΕΤΗ	ΕΛΕΓΧΟΣ	ΕΓΚΡΙΣΗ	ΗΜΕΡΟΜΗΝΙΑ
Ν. ΟΥΡΑΝΑΔΟΥ		Γ. ΤΙΟΡΑ	Α. ΠΑΝΑΓΙΩΤΑΚΗ	10-10-2006
Α.Δ.Μ.Η.Ε. ΔΙΕΥΘΥΝΣΗ ΝΕΩΝ ΕΡΓΩΝ ΜΕΤΑΦΟΡΑΣ				ΚΑΜΑΚΑ 1-20
ΤΟΜΕΑΣ ΕΡΓΩΝ Π.Ο.Δ. ΜΗΧ. Υ/Σ Κ.Υ.Τ.				50056